

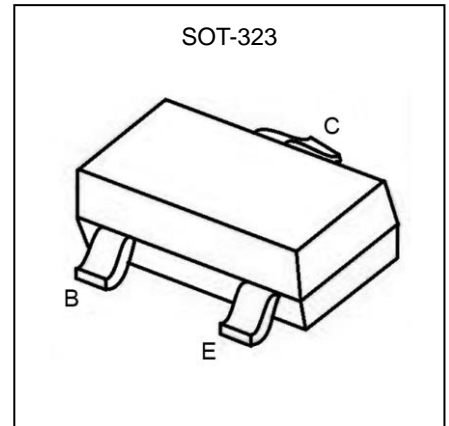

**MMST4403 Transistor(PNP)**

**Feature**

- Small Surface Mount Package



**MAXIMUM RATINGS (T<sub>a</sub>=25°C unless otherwise noted)**

Parameter	Symbol	Value	Unit
Collector-Base Voltage	V <sub>CB0</sub>	-40	V
Collector-Emitter Voltage	V <sub>CE0</sub>	-40	V
Emitter-Base Voltage	V <sub>EB0</sub>	-5	V
Collector Current -Continuous	I <sub>c</sub>	-0.6	A
Power Dissipation	P <sub>d</sub>	0.2	W
Junction Temperature	T <sub>J</sub>	150	°C
Storage Temperature	T <sub>STG</sub>	-55~ +150	°C

**ELECTRICAL CHARACTERISTICS(T<sub>a</sub>=25°C unless otherwise noted)**

Parameter	Symbol	Test Condition	Min	Max	Unit
Collector-base breakdown voltage	V <sub>(BR)CB0</sub>	I <sub>c</sub> =-100μA, I <sub>E</sub> =0	-40		V
Collector-emitter breakdown voltage	V <sub>(BR)CE0</sub>	I <sub>c</sub> =-1mA, I <sub>B</sub> =0	-40		V
Emitter-base breakdown voltage	V <sub>(BR)EB0</sub>	I <sub>E</sub> =-100μA, I <sub>C</sub> =0	-5		V
Collector cut-off current	I <sub>CB0</sub>	V <sub>CB</sub> =-35V, I <sub>E</sub> =0		-0.1	μA
Collector cut-off current	I <sub>CE0</sub>	V <sub>CE</sub> =-35V, V <sub>EB</sub> =-0.4V		-0.1	μA
DC current gain	h <sub>FE1</sub>	V <sub>CE</sub> =-1V, I <sub>c</sub> =-0.1mA	30		
	h <sub>FE2</sub>	V <sub>CE</sub> =-1V, I <sub>c</sub> =-1mA	60		
	h <sub>FE3</sub>	V <sub>CE</sub> =-1V, I <sub>c</sub> =-10mA	100		
	h <sub>FE4</sub>	V <sub>CE</sub> =-2V, I <sub>c</sub> =-150mA	100		300
	h <sub>FE5</sub>	V <sub>CE</sub> =-2V, I <sub>c</sub> =-500mA	20		
Collector-emitter saturation voltage	V <sub>CE(sat)</sub>	I <sub>c</sub> =-150mA, I <sub>B</sub> =-15mA		-0.4	V
		I <sub>c</sub> =-500mA, I <sub>B</sub> =-50mA		-0.75	V
Base-emitter saturation voltage	V <sub>BE(sat)</sub>	I <sub>c</sub> =-150mA, I <sub>B</sub> =-15mA	-0.75	-0.95	V
		I <sub>c</sub> =-500mA, I <sub>B</sub> =-50mA		-1.3	V
Transition frequency	f <sub>T</sub>	V <sub>CE</sub> = -10V, I <sub>c</sub> =-20mA, f =100MHz	200		MHZ

**Typical Characteristics**

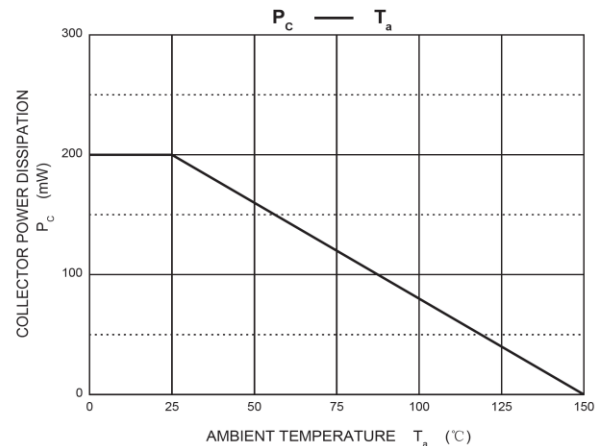
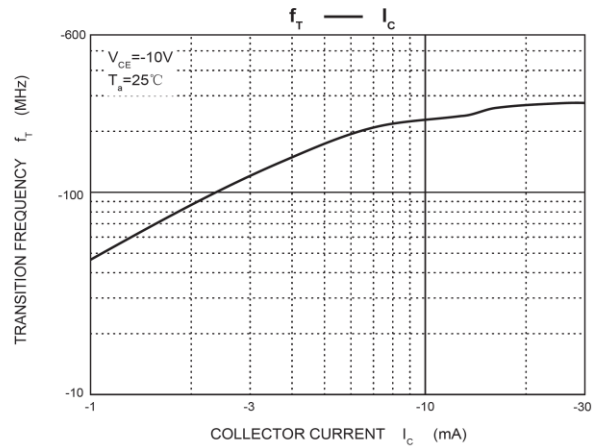
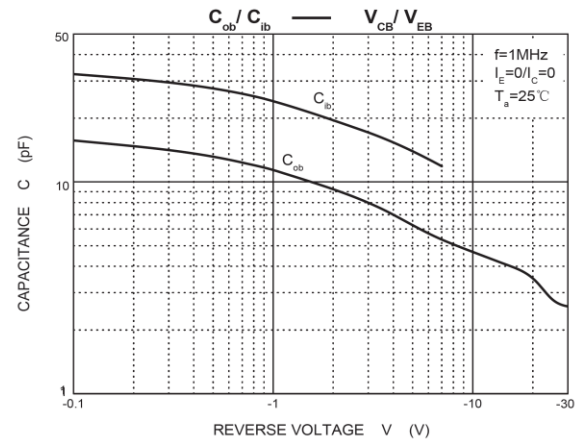
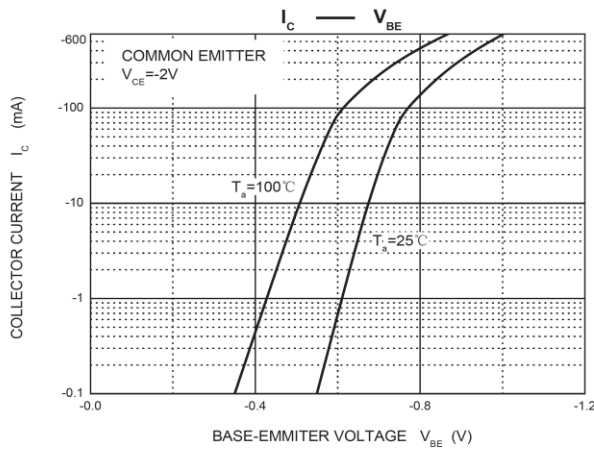
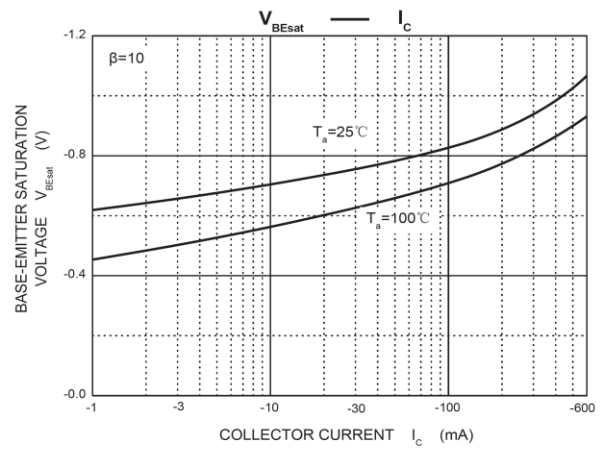
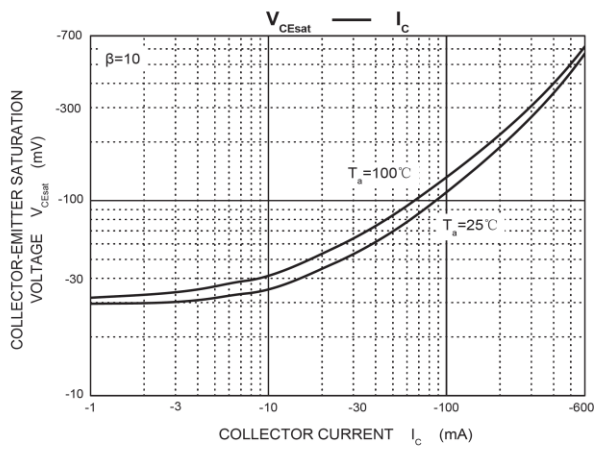
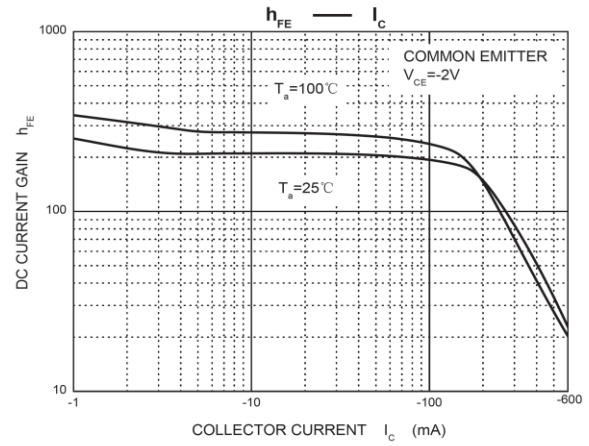
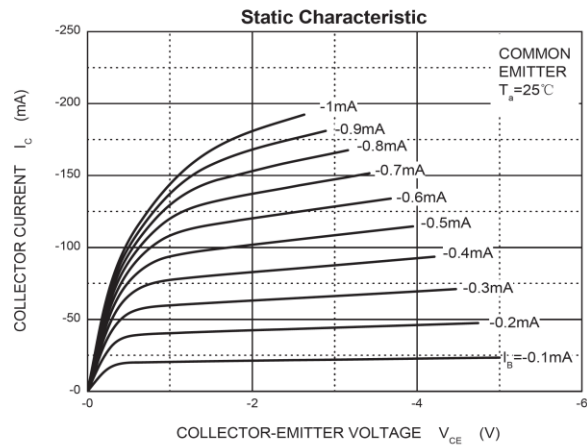

## SOT-323 Package Information

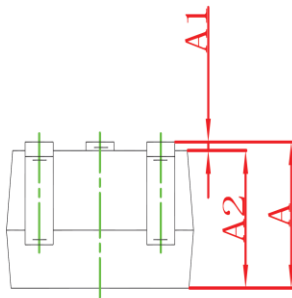
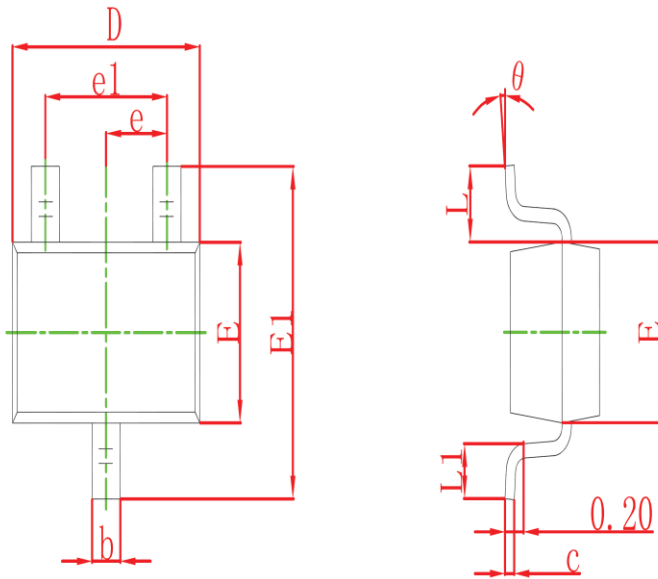

Symbol	Dimensions In Millimeters		Dimensions In Inches	
	Min	Max	Min	Max
A	0.900	1.100	0.035	0.043
A1	0.000	0.100	0.000	0.004
A2	0.900	1.000	0.035	0.039
b	0.200	0.400	0.008	0.016
c	0.080	0.150	0.003	0.006
D	2.000	2.200	0.079	0.087
E	1.150	1.350	0.045	0.053
E1	2.150	2.450	0.085	0.096
e	0.650 TYP		0.026 TYP	
e1	1.200	1.400	0.047	0.055
L	0.525 REF		0.021 REF	
L1	0.260	0.460	0.010	0.018
$\theta$	0°	8°	0°	8°

## SOT-323 Tape and Reel

### SOT-323 Embossed Carrier Tape

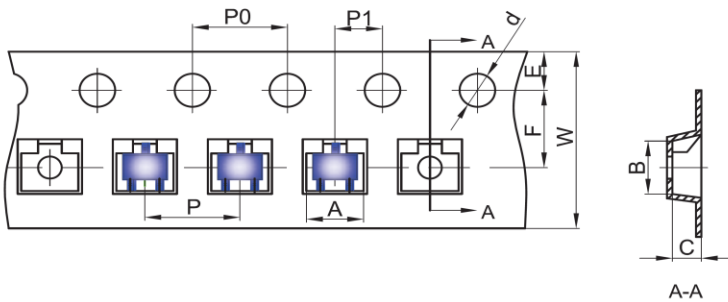

Dimensions are in millimeter										
Pkg type	A	B	C	d	E	F	P0	P	P1	W
SOT-323	2.25	2.55	1.19	Ø1.55	1.75	3.50	4.00	4.00	2.00	8.00

### SOT-323 Tape Leader and Trailer

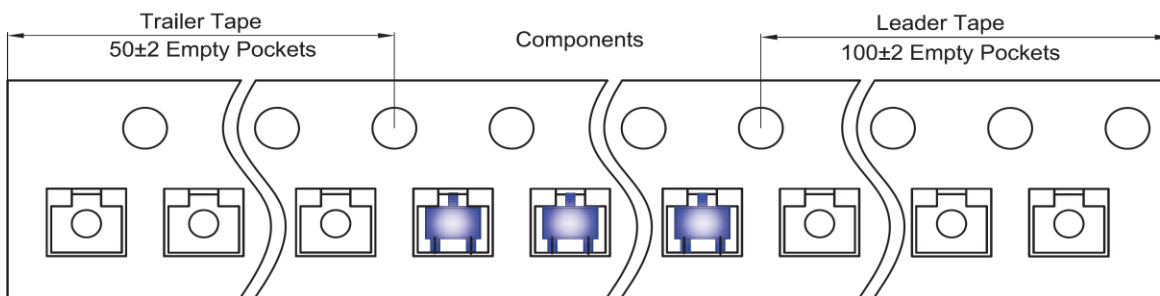

### SOT-323 Reel

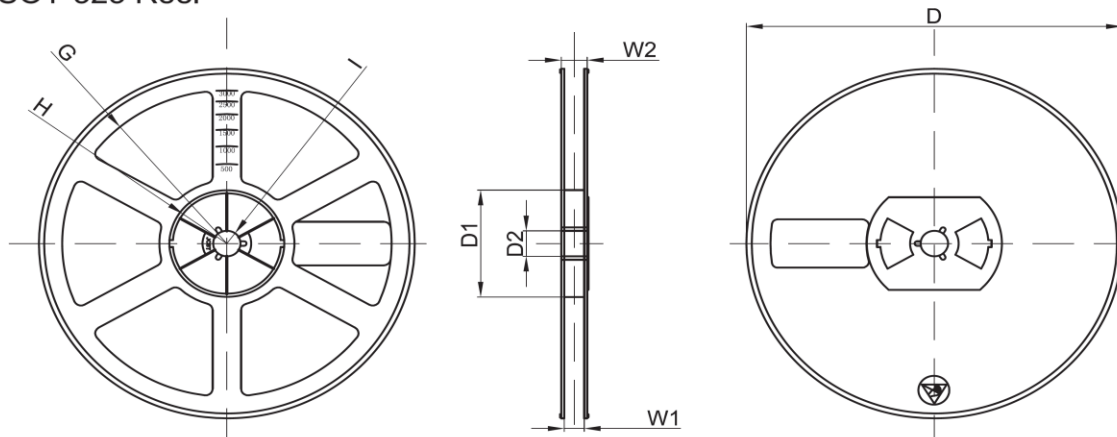

Dimensions are in millimeter								
Reel Option	D	D1	D2	G	H	I	W1	W2
7" Dia	Ø178.00	54.40	13.00	R78.00	R25.60	R6.50	9.50	12.30

REEL	Reel Size	Box	Box Size(mm)	Carton	Carton Size(mm)	G.W.(kg)
3000 pcs	7 inch	45,000 pcs	203×203×195	180,000 pcs	438×438×220	